



Baffle Install Procedure (With Z Channel supplied by Troy Acoustics)

*If Wood Furring will be used in lieu of Z Channel, fastener "D" must be used instead of fastener "B"

1. Z Channel to be zipwelded to armor plate by baffle manufacturer.
2. Once all Z Channel has been attached, use a spray adhesive (3M-90 or equal) to secure 2" Troy Wool to underside of baffle surface fitting tight in between each channeling. The spray adhesive is to hold the Troy Wool in place until the Troy Board material is attached. Use a 10" serrated knife to cut the Troy Wool if cuts are required. Cover entire designated surface with Troy Wool.
3. Start layout of 1" Troy Board perpendicular to Z Channel. Start at the top of the baffle with the 23 3/8" side parallel to Z Channel. The board must sit flush against the Z Channel and the top side MUST BE LEVEL. Cover entire designated surface with Troy Board.
4. Using the supplied fasteners "B" and "F", attach Troy Board to Z Channel every 3" from all edges and side. Field placement is at every furring element in a straight line. There are typically 10 fasteners per Troy Board. Troy Board is a finish acoustic material. Make sure joints are tight. Troy Board is to be installed without edges damaged. Troy Board may be cut using a circular saw, hand saw, or reciprocating saw type. The Troy Board is manufactured with Portland cement; thereby dust will be created when using a circular saw.

1" TROY BOARD FASTENED TO Z CHANNEL USING FASTENER "B" & "F" AS PER INSTALLATION PROCEDURE

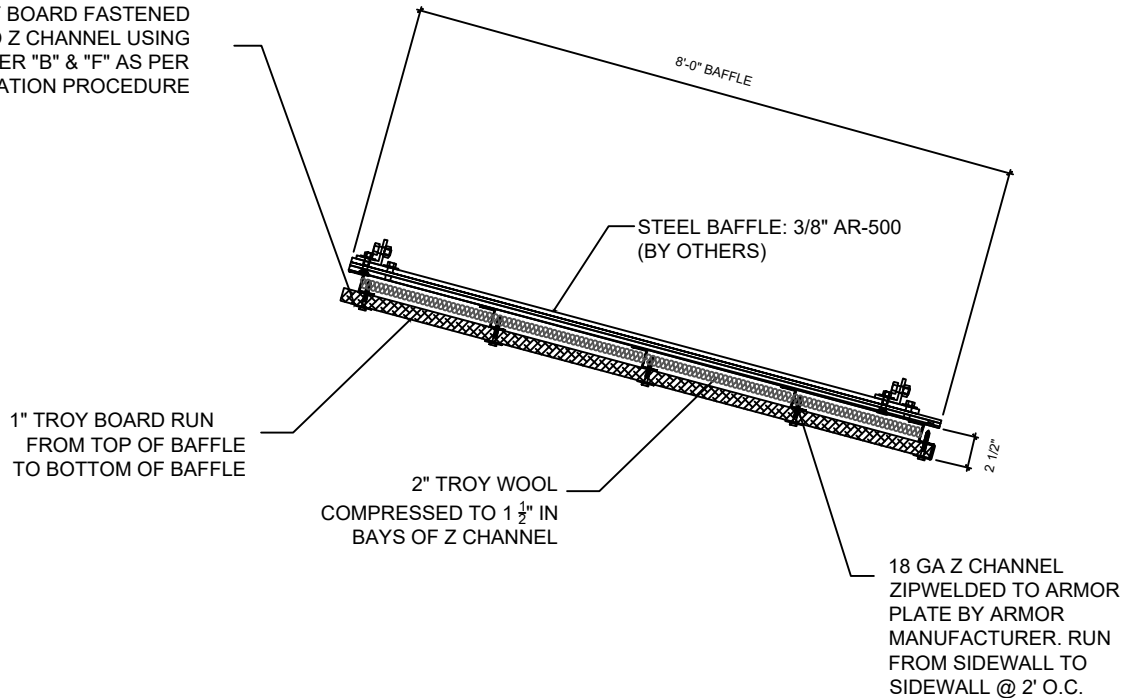

FASTENERS

B $\frac{1}{4}$ " x 2" SELF TAPPING HEX HEAD SCREW USED TO FASTEN 1" BOARD TO Z CHANNEL



D $\frac{1}{4}$ " x 2" LAG SCREW USED TO FASTEN 1" BOARD TO WOOD FURRING



F $\frac{1}{4}$ " x 1 $\frac{1}{4}$ " FENDER WASHER USED IN COORDINATION WITH FASTENER "A" TO FASTEN 1" BOARD TO Z CHANNEL



1 BAFFLE DETAIL (SIDE VIEW)

- NTS

REVISIONS:

DRAWN BY: TCB

DATE: 7-20-22

SCALE: AS NOTED

BAFFLE
DETAIL

SHEET #

-